

Plat of Survey

of

Lot 7 of Pickerel Jay Ranch,

a subdivision located in the Northwest 1/4 of Section 12,
Town 4 North, Range 17 East, Town of Troy,
Walworth County, Wisconsin.

Surveyed for: **Jerry Arntson**
W2709 Secretariat Drive
East Troy, Wisconsin. 53120

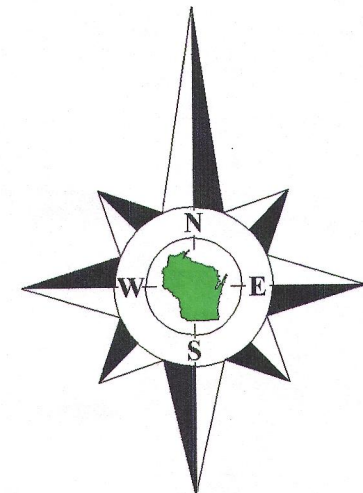

Bearings reference to the
plat of Pickerel Jay Ranch.

Secretariat Drive

(66' Wide)

Culvert
(East)

N89°39'32"E

23.05'
(23.06')

Arc=47.76'

Chord=S69°10'23"E 46.73'
(S69°17'43"E 46.67')
Radius=66.00'

Arc=74.20'

Chord=S80°48'11"E 70.36'
(S80°47'43"E 70.35')
Radius=66.00'

Found Pipe Bent,
Dug down 1' until
straight. Reset
pipe in hole.

Arc=93.85'

Radius=66.00', Chord=S26°04'49"W 86.14'
(S26°15'00"W 86.16')

Lot 8

N3°40'57"E 285.02'
(N3°39'52"E 284.97')

House
W2709

Patio

Well

Lot 7

Tax Parcel
LP 00007

1.291 Acres
56,241 Sq.Ft.

Proposed
Garage

Lot 6

S27°29'30"E 289.39'
(S27°40'02"E 289.40')

Shed
12.3' 12.0'

West 288.07'
(West 288.16')

Tax Parcel
LT 1200007D

I, Douglas G. Olson, Wisconsin Professional Land Surveyor, do hereby certify that this survey was performed by me, or under my direction in full compliance with the owner's/agent's instructions and Chapter A-E 7 of the Wisconsin Administrative Code "Minimum Standards for Property Surveys"; and that this map is an accurate representation thereof to the best of my knowledge and belief.

Notes:

- 1) This survey plat is not certified unless signed and sealed in red ink.
- 2) This survey is subject to Wisconsin lien laws. This Plat of Survey is the notice of intent to file lien. Lien waiver required.

Copyright 2016 by Olson Land Surveying, LLC.

All rights reserved. No part of this survey plat may be reproduced or transmitted in any form by any means - graphic, electronic, or mechanical, including photocopying, tracing, or information storage and retrieval systems - without permission in writing from Douglas G. Olson, Olson Land Surveying, LLC.

Douglas G. Olson
Wisconsin Professional Land Surveyor - 2093

Center 1/4 Corner
Section 12-4-17
N. 303,305.89
E. 2,420,020.88

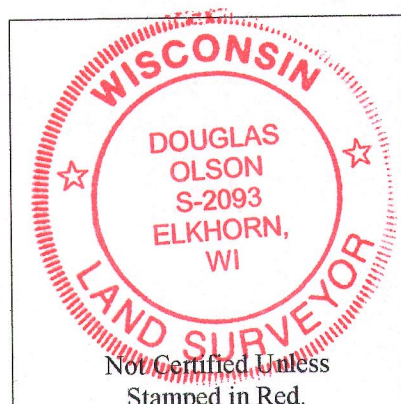

Legend

- Found County Section Corner
- Found Iron Pipe
- Set Iron Pipe, 1" dia.
- Recorded Information
- Utility Box or Pedestal
- Concrete Cover
- Septic Vent
- Asphalt Surface
- Concrete
- Brick Pavers

Olson Land Surveying, LLC

45 South Wisconsin Street * P.O. Box 322 * Elkhorn, Wisconsin. 53121
Telephone: (262) 723-3434 * Facsimile: (262) 723-8044
Email: doug@olsonsurveying.com

Scale in Feet
1" = 20'

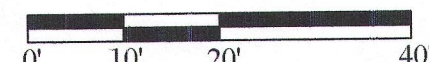

Survey Date: June 14, 2016.
Revisions:

2016.056

Sheet 1 of 1 Sheets

Drawing Name:

Job Reference Number

2016.056

LP-7 417-1019